

State of South Carolina Below the Indian line

Pursuant to a warrant from John Thomas Esq. Commissioner of Locations Northside of Saluda River bearing date the 15th July 1784, I have admeasured and laid out unto John Blasingame a tract of land containing three hundred acres on waters of fairforest - 50 2000
and branch called Salays Creek bounding East on vacant land south on vacant land -
W. part on vacant land & part on widow Little's -
S. side of land N. on vacant land and hath such shape and marks as the annexed Plat represents. Surveyed the 16th July 1784
Recorded the 24th Sept. 1784 Phil. Waters Esq.

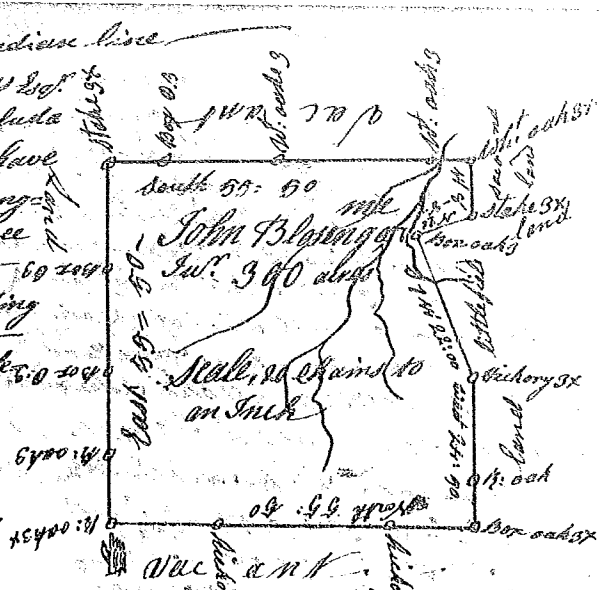

State of South Carolina Below the Indian boundary

Pursuant to a warrant from John Thomas Esq. Commissioner of Locations on the North side of Saluda River bearing date the 25th day of June 1784, I have admeasured and laid out unto James Blasingame a tract of land containing eighty five acres on waters of fairforest & branches of Mitchell's Creek bounding S.W. on Col. Waters land & on Mr. Foyson's land N.E. and S.E. on Capt. Thomas Blasingame's land N.E. on Mr. Plummer's land and hath such shape and marks as the above plat represents. Surveyed the 16th July 1784
Recorded the 24th Sept. 1784

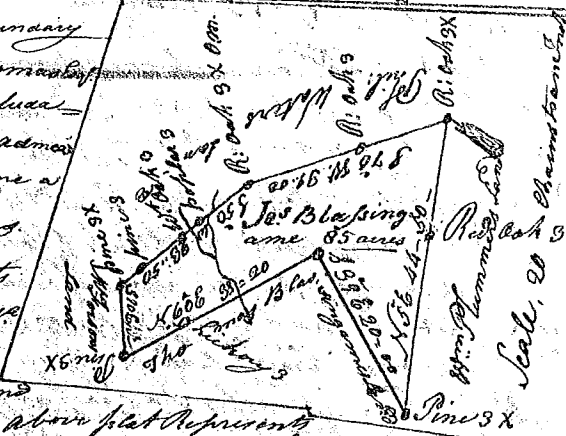

South Carolina

Pursuant to a precept Directed Under Hand and seal of John Bremer Esq. Depy. Gov. bearing date the 2nd of July 1779, I have admeasured and laid out unto William Browning a plantation or tract of land containing one hundred & fifty acres in Chatham County situated on Sugar creek a branch of fairforest and bounding N.W. by James Martins land S.W. by Richard Bryant's land N.E. & S.E. by Nathaniel Howards land and hath such shape and marks as the annexed plat represents. Surveyed the 16th July 1779
Recorded the 24th Sept. 1784 W. S. S. Esq.

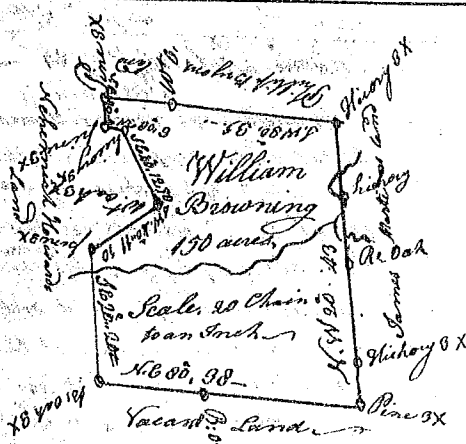

State of South Carolina

Pursuant to a warrant from John Thomas Esq. Commissioner of Locations, I have admeasured and laid out unto Samuel Otterson a tract of 200 acres of land situated in Ninety six District on the waters of Sugar River bounding N.E. on Standley's land N.W. on land of James Orr S.W. on land of James Hughly S.E. on William Wellons line & then on Samuel Ottersons line and hath such shape and marks as the annexed Plat represents. Surveyed the 27th of August 1784
Recorded the 24th Sept. 1784 David Hopkins Esq.

